



## Plan 18-066

4 Bedrooms, 2 Baths  
1,819 Total Square Feet

*Offered By*

**Hugh Cole Builder, Inc.**

**Hugh Cole**

334.657.6161

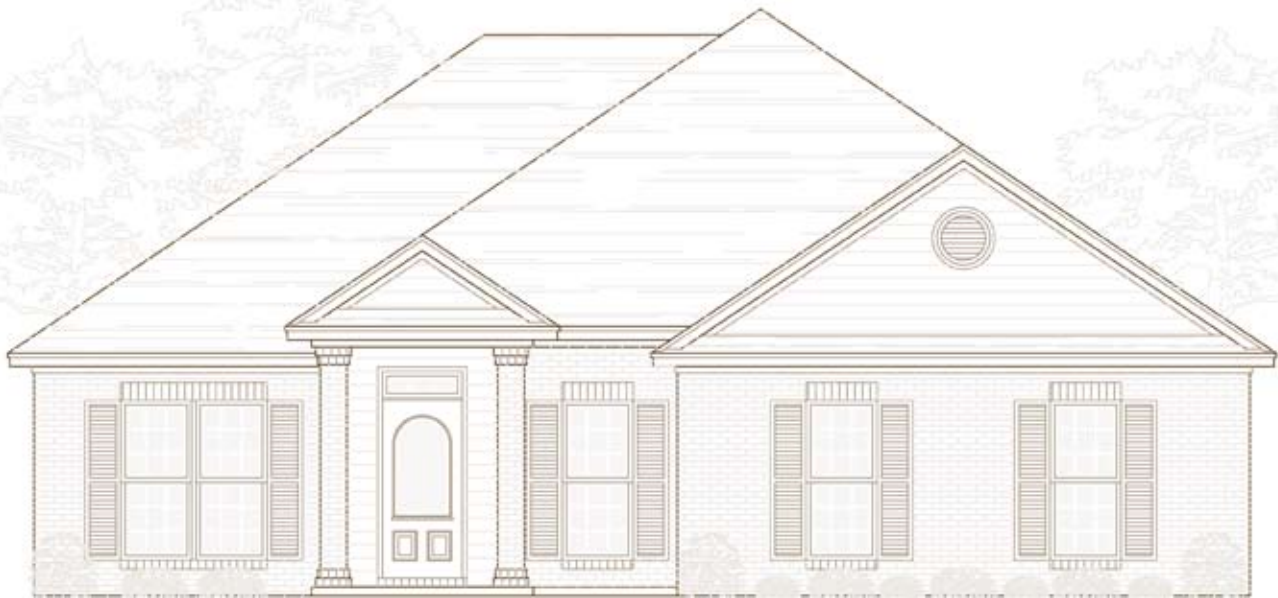

# NEW PARK

The new neighborhood from **Jim Wilson and Associates**



Jim Wilson & Associates, LLC





## Plan 18-066

4 Bedrooms, 2 Baths  
1,819 Total Square Feet

Offered By

**Hugh Cole Builder, Inc.**

**Hugh Cole**

334.657.6161

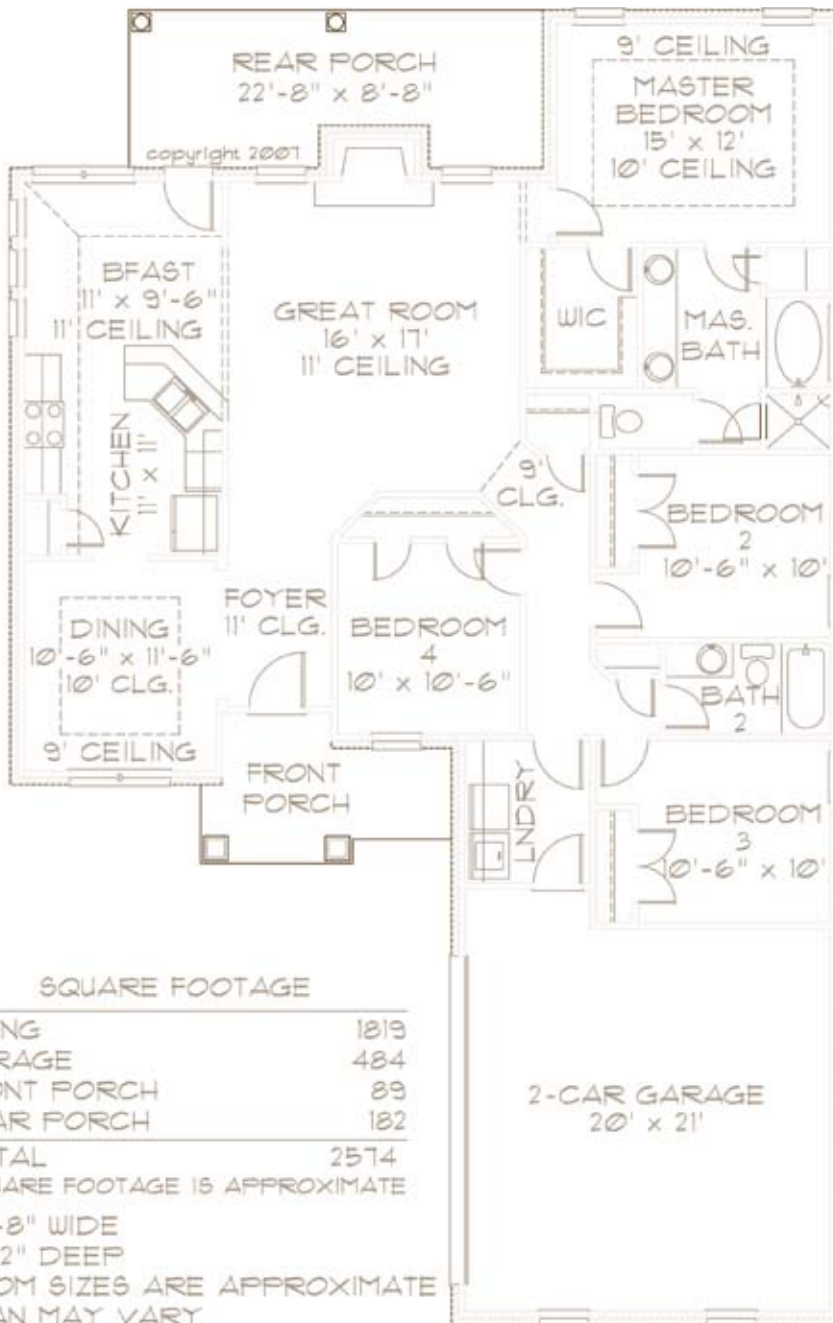

### SQUARE FOOTAGE

LIVING	1819
GARAGE	484
FRONT PORCH	89
REAR PORCH	182
TOTAL	2574

\*SQUARE FOOTAGE IS APPROXIMATE

45'-8" WIDE

72'-2" DEEP

ROOM SIZES ARE APPROXIMATE

PLAN MAY VARY

PLAN #18-066

# NEW PARK

The new neighborhood from **Jim Wilson and Associates**



Jim Wilson & Associates, LLC

